



Model Number:  
**CPL10L1P-4312**

RF Components

# 10 dB Multi-Coupler Module

## 900-1500 MHz

- For use in ETL panel model CST-VIA-CPL-1008
- 2 coupled ports on the rear, 1 port on the front
- RF in/out ports also located on rear of unit

Available with RF connector options:

- 50 Ω SMA

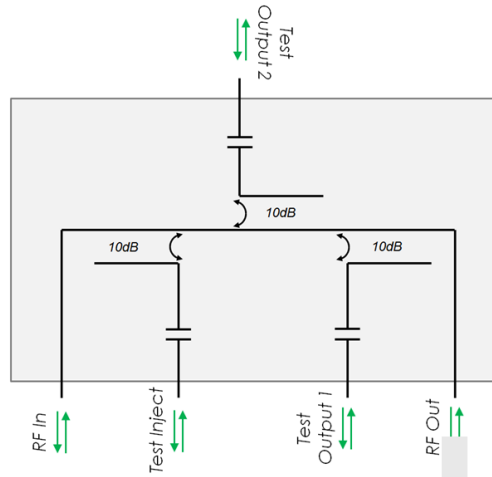

# Coupler

RF Parameters	
Frequency Range	900-1500 MHz
RF Connectors	50Ω SMA
Insertion Loss	2.0 dB min
Flatness	±0.28dB
Coupled Port Insertion Loss*	11.2 dB typ
	12.0 dB max
Input Return Loss	24 dB typ
	20 dB min
Output Return Loss	24 dB typ
	20 dB min
Coupled Port Return Loss	20 dB typ
	16 dB min
Directivity	15 dB typ
	10 dB min

Environmental	
Operating Temperature	0°C to 45°C
Storage Temperature	-20°C to +75°C
Location	Indoor use Only
Humidity	85% non-condensing
Altitude	3,000m (~10,000ft) Above Mean Sea Level

Max Operating Parameters	
Input RF Power	+37 dBm (5W)
DC Voltage	35V on any RF port
DC Current	N/A

\* Coupled port Insertion loss is relative to the input port, typical Coupling of the unit is 10dB.

### Broadcast



### Marine Oil & Gas



### SNG & VSAT



### Satellite Teleport





RF Components

Model Number:  
**CPL10L1P-4312**  
10 dB Multi-Coupler Module

### Port Layout

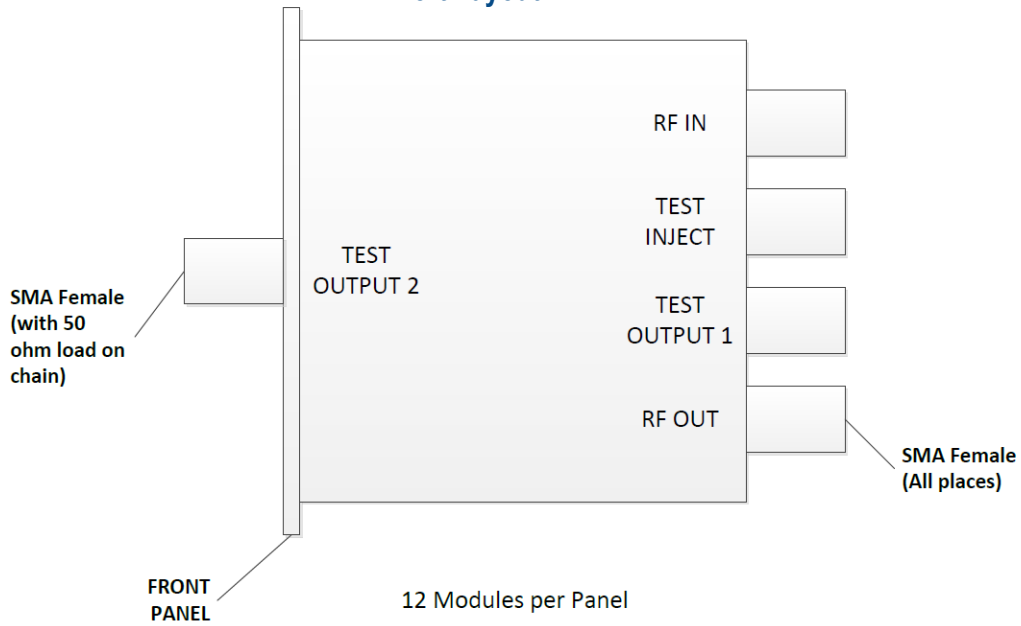

### Physical Dimensions (mm)

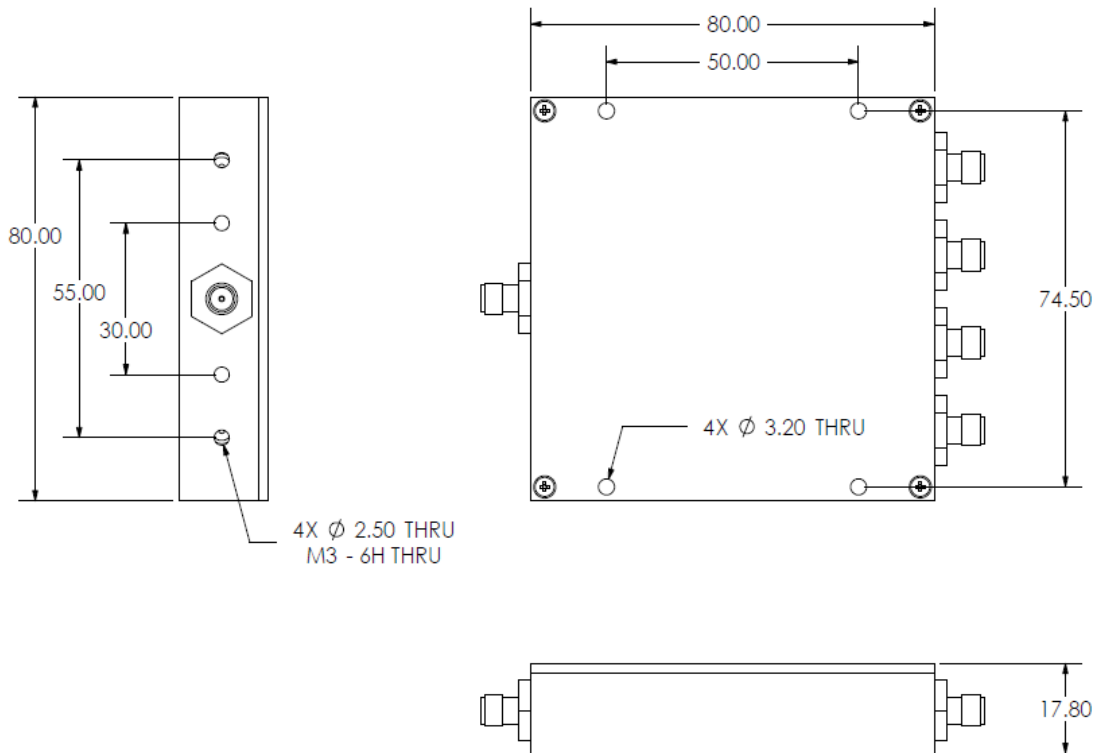

Note: The specification is subject to regular reviews and will be updated from time to time as part of our continuing product development and improved specification accuracy.

ETL SYSTEMS LIMITED  
Coldwell Radio Station  
Madley  
Hereford  
England HR2 9NE

TELEPHONE  
+44 (0)1981 259020  
  
EMAIL  
info@etlsystems.com

FACSIMILE  
+44 (0)1981 259021  
  
WEB  
www.etlsystems.com

